

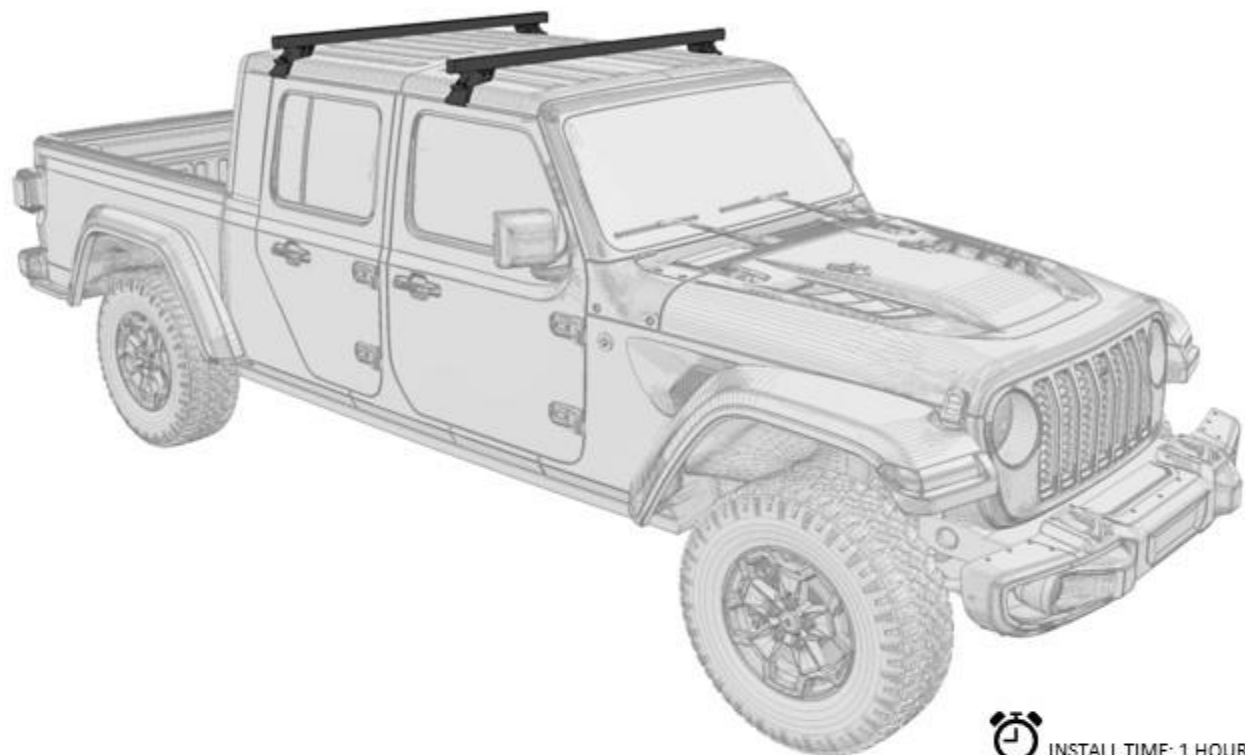

ApexOEM

321181-JEEP GUTTER MOUNT CROSS BARS



INSTALL TIME: 1 HOUR

TOOLS REQUIRED

A	RATCHET
B	7/16" WRENCH
C	TAPE MEASURE
D	5/32" ALLEN KEY
E	7/16" SOCKET

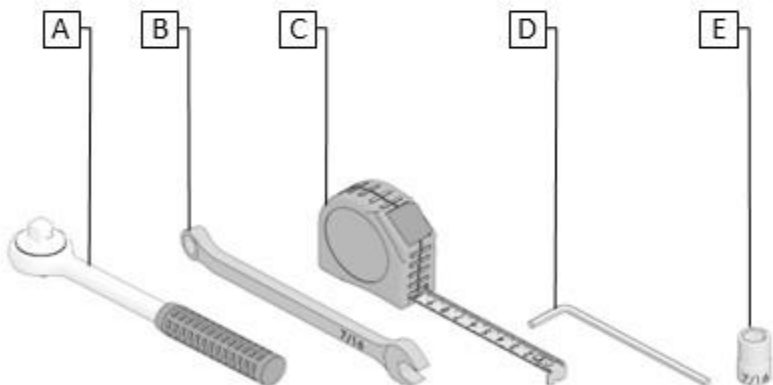



ApexOEM

321181-JEEP GUTTER MOUNT CROSS BARS

PARTS LIST

ITEM	QTY.	DESCRIPTION	PART NO.
1	2	60" CARGO RAIL	32111-1001
2	2	60" CHANNEL COVER	321182-1000
3	4	BASE BRACKET	32118-1000
4	4	CLAMP BRACKET	32118-1001
5	4	LH SUPPORT BRACKET	32118-1002LH
6	4	RH SUPPORT BRACKET	32118-1002RH
7	8	ADHESIVE BACKED RUBBER PAD	32118-1003
8	4	RUBBER TRIM	
9	4	END CAP	X20173121
10	4	DOUBLE STRUT NUT	201425-02
11	8	¼"-20 X 1" BUTTON HEAD SCREW	
12	16	¼"-20 X 3/4" BUTTON HEAD SCREW	
13	8	¼" HEX HEAD SCREW	
14	8	¼" NYLON INSERT LOCK NUT	
15	40	¼" FLAT WASHER	

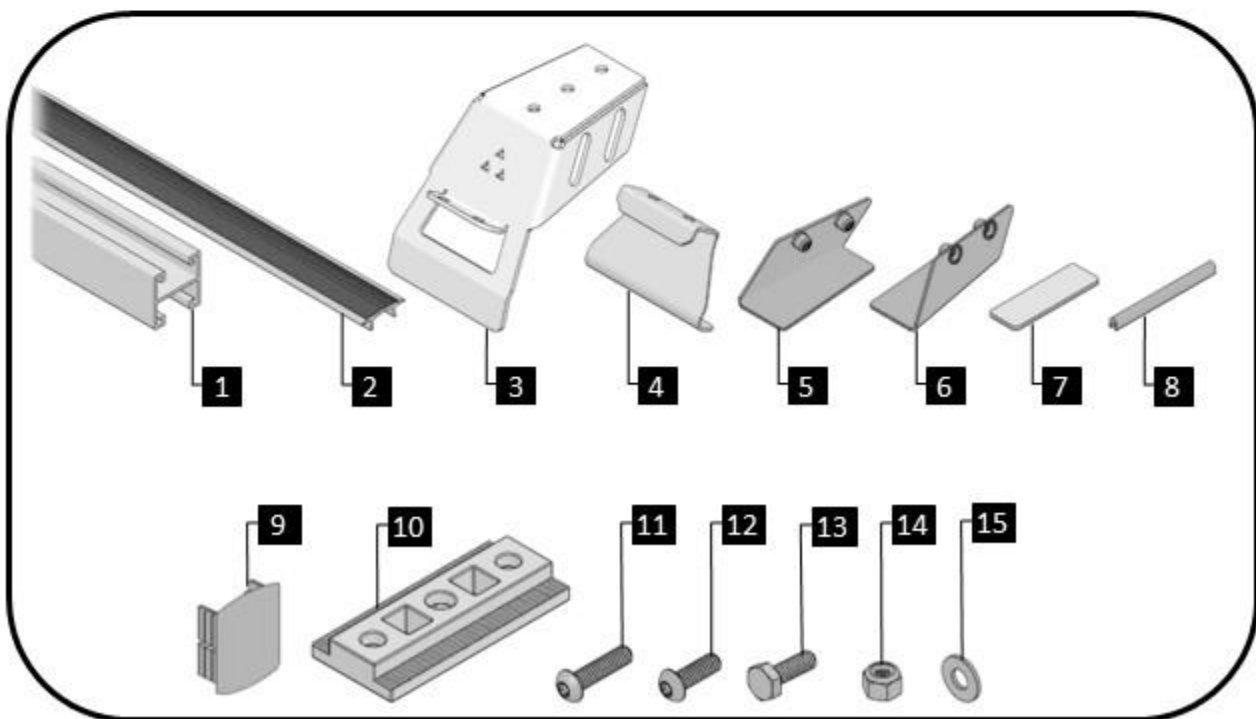

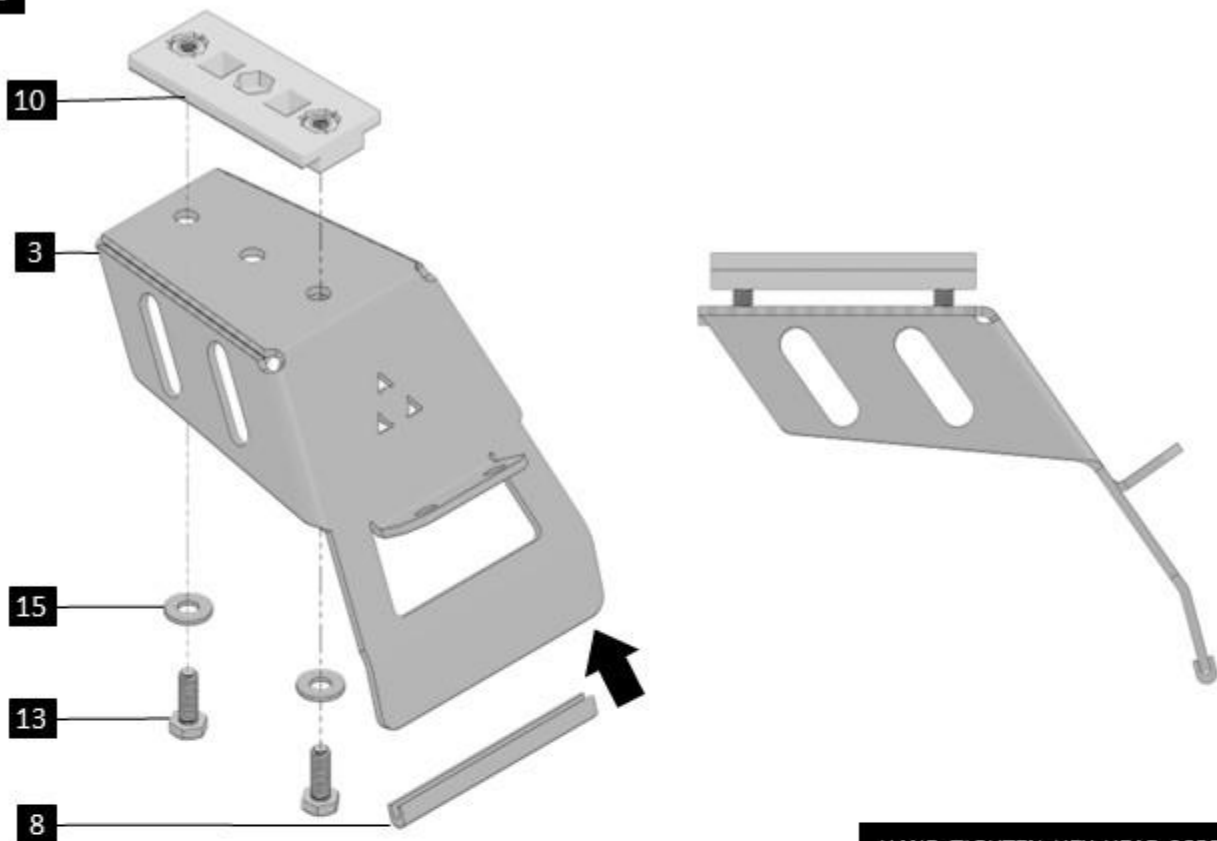
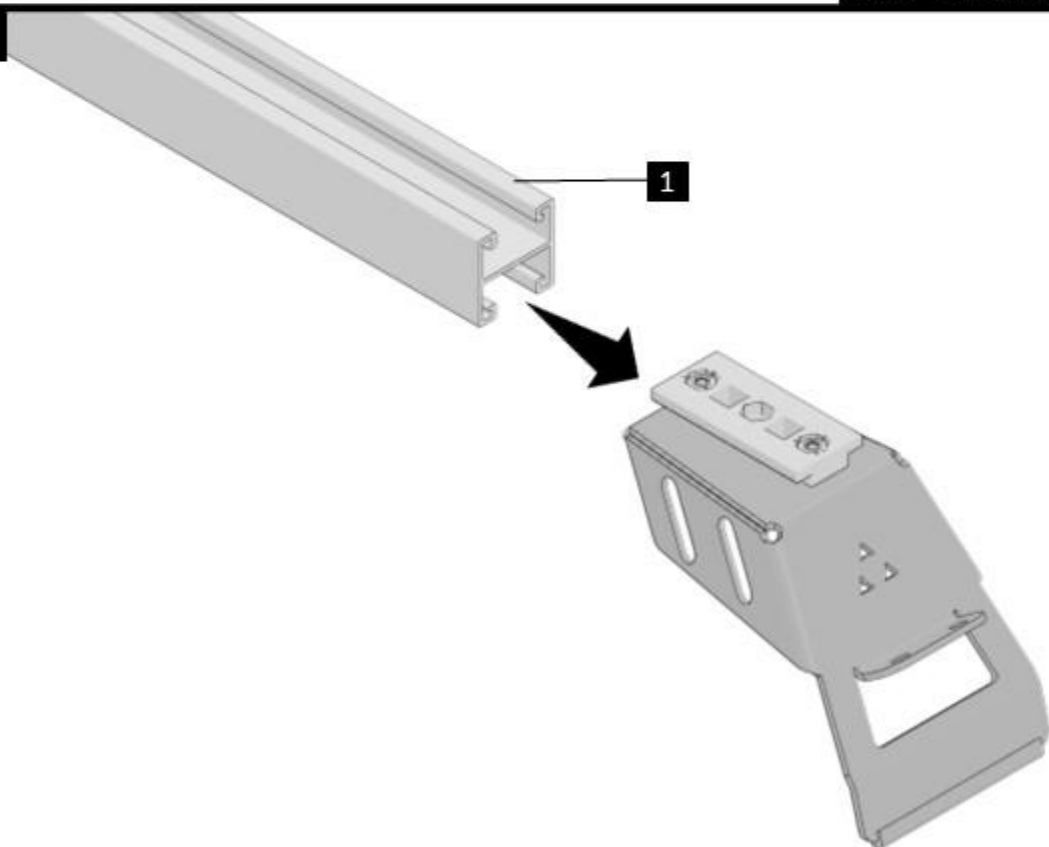
1**HAND TIGHTEN HEX HEAD SCREWS.****2**

3

SLIDE CHANNEL INTO BOTH BRACKETS.

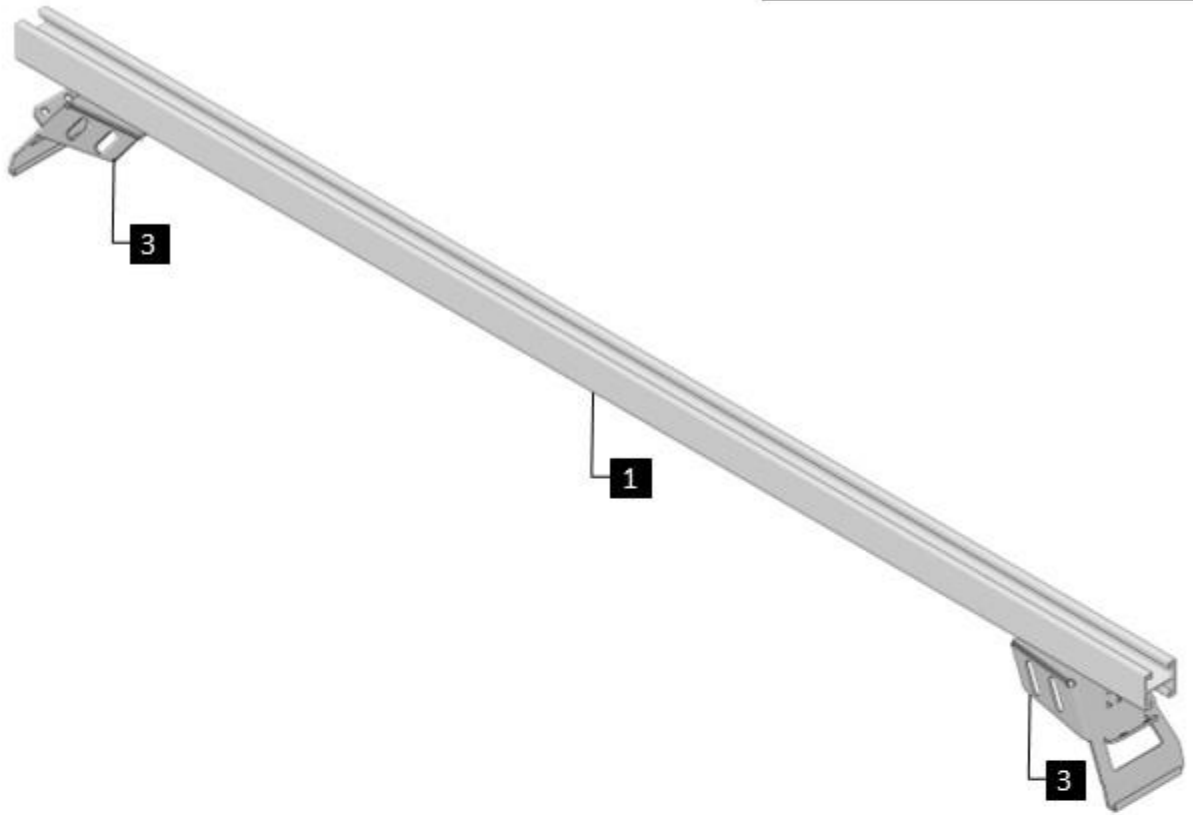

4

MEASUREMENT "A" AND "A" TO BE EQUAL

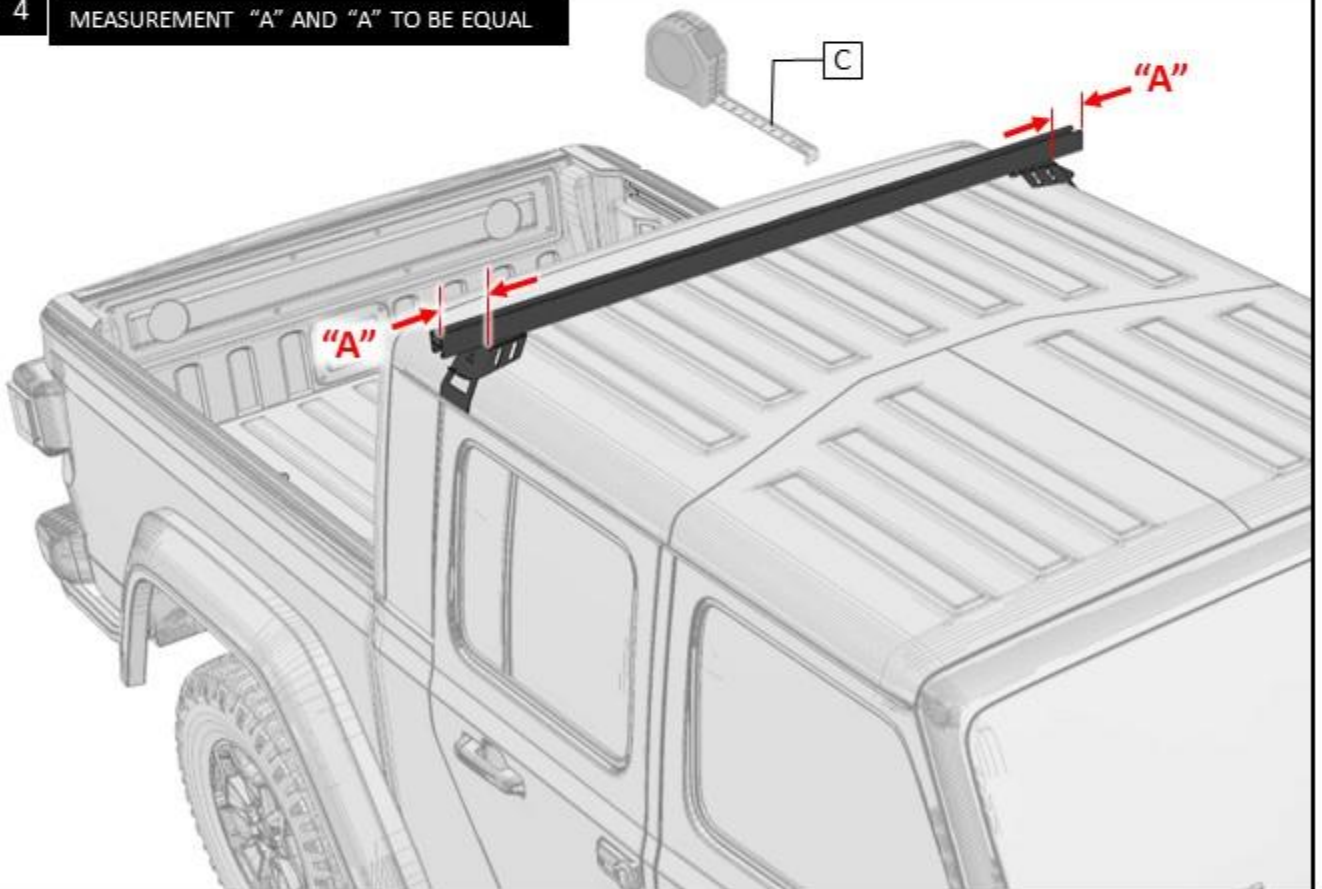

5

MEASUREMENT "A" AND "A" TO BE EQUAL

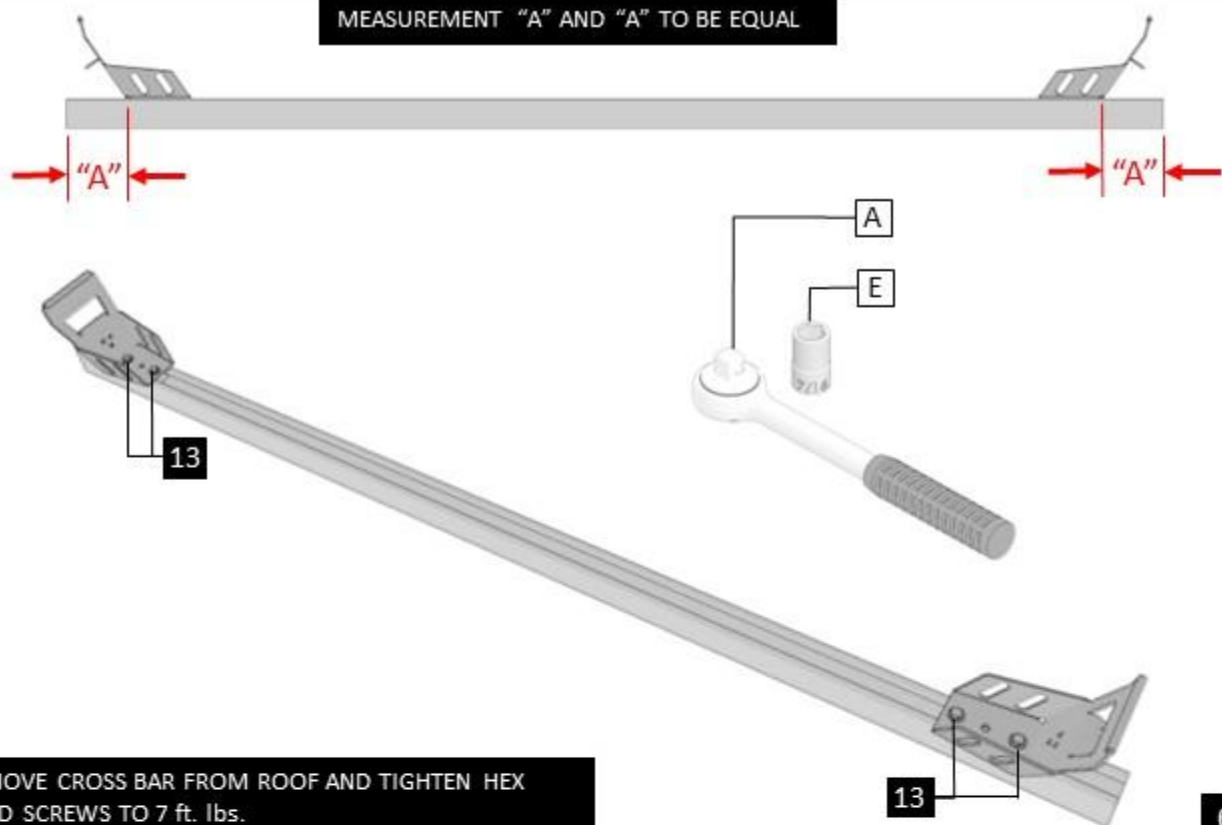

REMOVE CROSS BAR FROM ROOF AND TIGHTEN HEX HEAD SCREWS TO 7 ft. lbs.

6

7

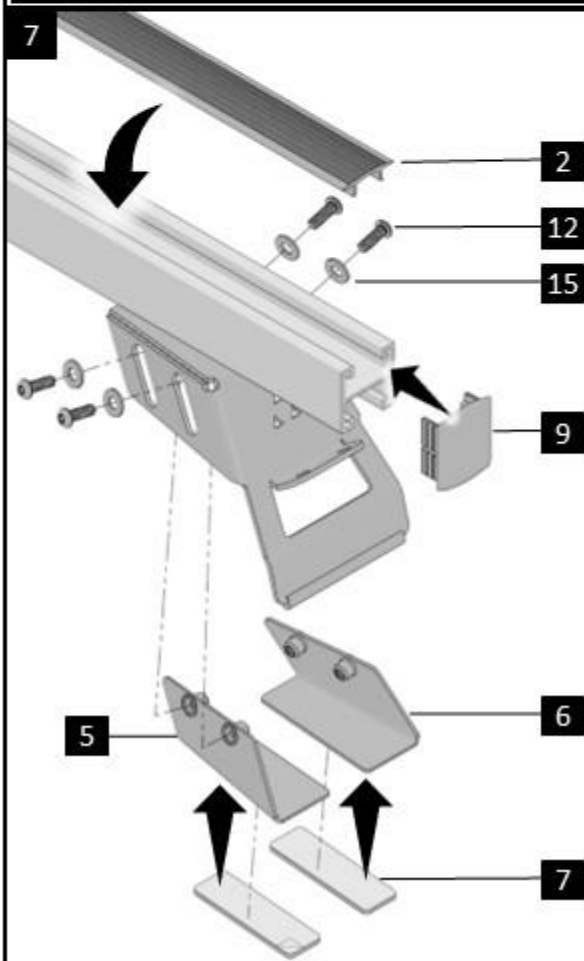

DO NOT FULLY TIGHTEN ITEM 12, BUTTON HEAD SCREWS.

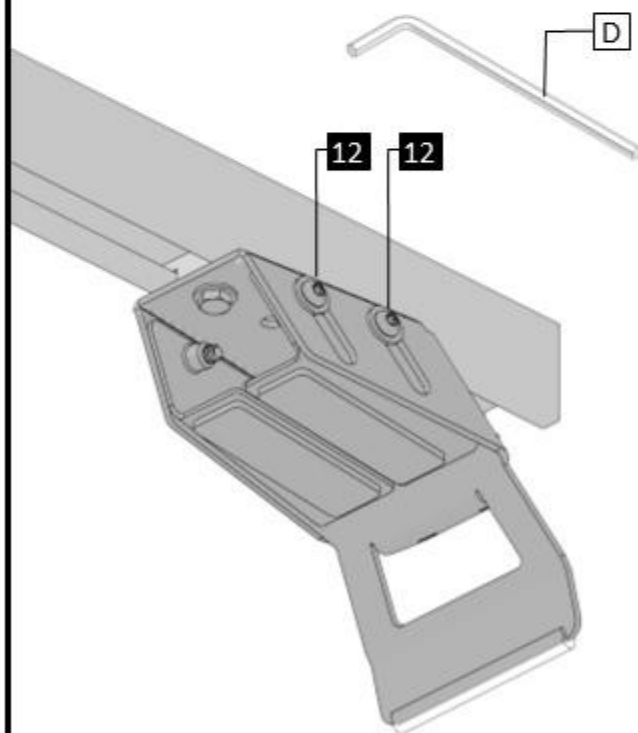

5

12
X4

5, 6

D

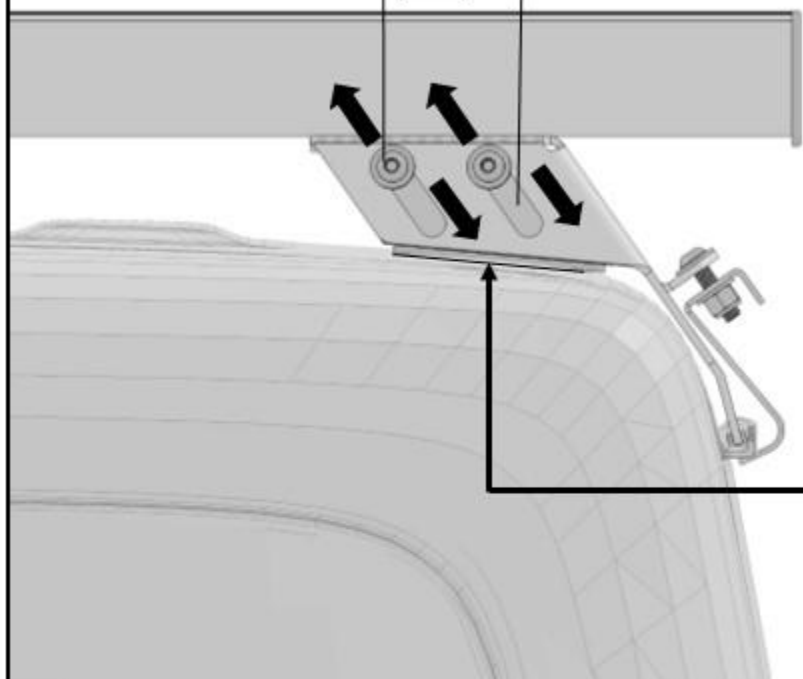

RUBBER PAD TO BE RESTING ON ROOF, TIGHTEN BUTTON HEAD SCREWS.

6

7

TIGHTEN CLAMP BRACKET TO SECURE BASE, 4X.

A

D

E

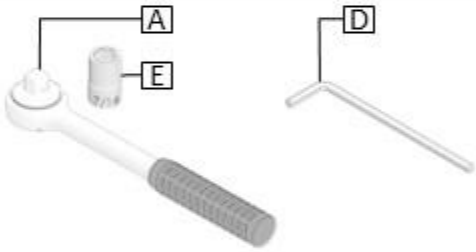

4

11

15

4

14

